

PROTECTIVE GLASSES FOR PHOTOTHERAPY



Protective glasses MDM

are designed to protect the eyesight of newborns in all neonatal wards treating hyperbilirubinemia using phototherapy lamps of all types.

The very simple application, reliable fixation and quality material of this aid are features that make it suitable for use in most neonatal wards.

The goggles come in two sizes - small and medium.

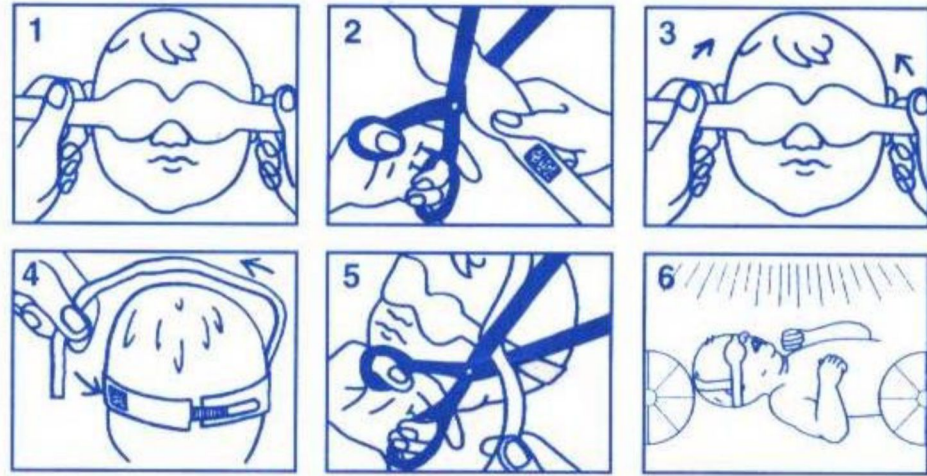

Technical parameters

▪ Protective glasses small-circumference	24	cm
▪ Protective glasses medium-circumference	30	cm



Alfamedic s.r.o

Tř. 5.května 458/35, 37372 Lišov, Czech Republic

T: 387 994 664

alfamedic@alfamedic.cz, www.alfamedic.cz

